



Windelo

OCEAN FUTURE



Ecology



Performance



Comfort

The Windelo spirit: eco-friendly catamarans

Located in Canet-en-Roussillon since 2019, Windelo catamaran is a young shipyard that builds eco-friendly, performant, innovative, and comfortable catamarans. Inspired by deep family values and passion for nautical activities, Olivier Kauffmann and his son Gautier Kauffmann created Windelo in 2018. In partnership with researchers from Mines d'Alès, a renowned engineering school in France, they carried out several years of Research and Development to build environmentally-friendly catamarans.

" Windelo sailors crave adventure and love to explore. We like to clock up miles between islands and continents without giving up the comfort of life on board. With ecology & innovation at the heart of our company, we're taking up the challenge to build light & spacious boats respectful of people and the environment, offering optimum performance, and being a pleasure to sail.

Because we are all different and none of our adventures are alike, we choose unique boats for an extraordinary life experience.

We are the Windelo sailors, welcome to the adventure! "

Our values



ECOLOGY

Our love of the planet has been the driving force behind our environmentally friendly boats. We aim to reduce the environmental impact of our catamarans by 50%.



INNOVATION

R&D and innovation in materials, design and processes are at the heart of the Windelo project to combine ecology, performance, and comfort.



PERFORMANCE

We're taking up the challenge to build light & spacious boats respectful of people and the environment, offering optimum performance, and being a pleasure to sail.



COMFORT

Windelo sailors crave adventure and love to explore. We like to clock up miles between islands and continents without giving up the comfort of life on board.

WINDELO 54

Bigger sister of the Windelo 50, the Windelo 54 is an ocean-cruising catamaran designed by architect duo Christophe Barreau and Frédéric Neuman. The floats are nearly 120 cm larger than Windelo 50 (60 cm of this extra space is around the nacelle), making life on board even more pleasant and comfortable.

Our Windelo 54 catamarans are environmentally friendly, seaworthy, and designed for long-distance cruising. Lengthened hulls offer greater performance and speed under sail while improving cruising comfort, particularly in rough seas.

Available in 3 versions: ADVENTURE / YACHTING / SPORT



TECHNICAL DETAILS OF THE WINDELO 54

DIMENSIONS

Adventure **Yachting** **Sport**

Length	16.24 m		
Beam	7.98 m		
Draft of standard version	1.05 / 2.35m		
Light displacement	12.8 T	12.8 T	12.3 T
Freshwater tank	400 L		
Blackwater tank	200 L		
Max. number of cabins	4 (+ 1 skipper)		
Max. number of people	12		

SAIL

Type of rigging	Sloop
Sail area upwind	193 m ²
Sail area downwind	267 m ²
Mainsail area	98 m ²
Foresail area	45 m ²
Gennaker area	169 m ²

HULL

Type of appendage	Daggerboards
Appendages available on option	Fixed shallow draft keel
Hull materials	Basalt and PVC/PET foam sandwich
Deck materials	Basalt and PET foam sandwich
Type of helm	Twin steering wheels

MOTORIZATION

Type of engines	Electric and hybrid engines
Engines power	Electric 2 x 20 kW
Generator	18 kW (or 2 x 18 kW on option)
Engine transmission type	Shaftline
Energy type	Electricity and diesel
Battery park	1 120 Ah on option
Green energies	Solar, hydrogeneration, wind turbine
Fuel tank	500 L

PRICE

Adventure **Yachting** **Sport**

Starting price in Electric-hybrid	995 000 € EX-VAT	1 075 000 € EX-VAT	1 125 000 € EX-VAT
-----------------------------------	---------------------	-----------------------	-----------------------

LAYOUT PLANS OF THE WINDELO 54

The floats layout plans can be adapted for each basket layout.

Nacelle fitted with a U-shaped galley

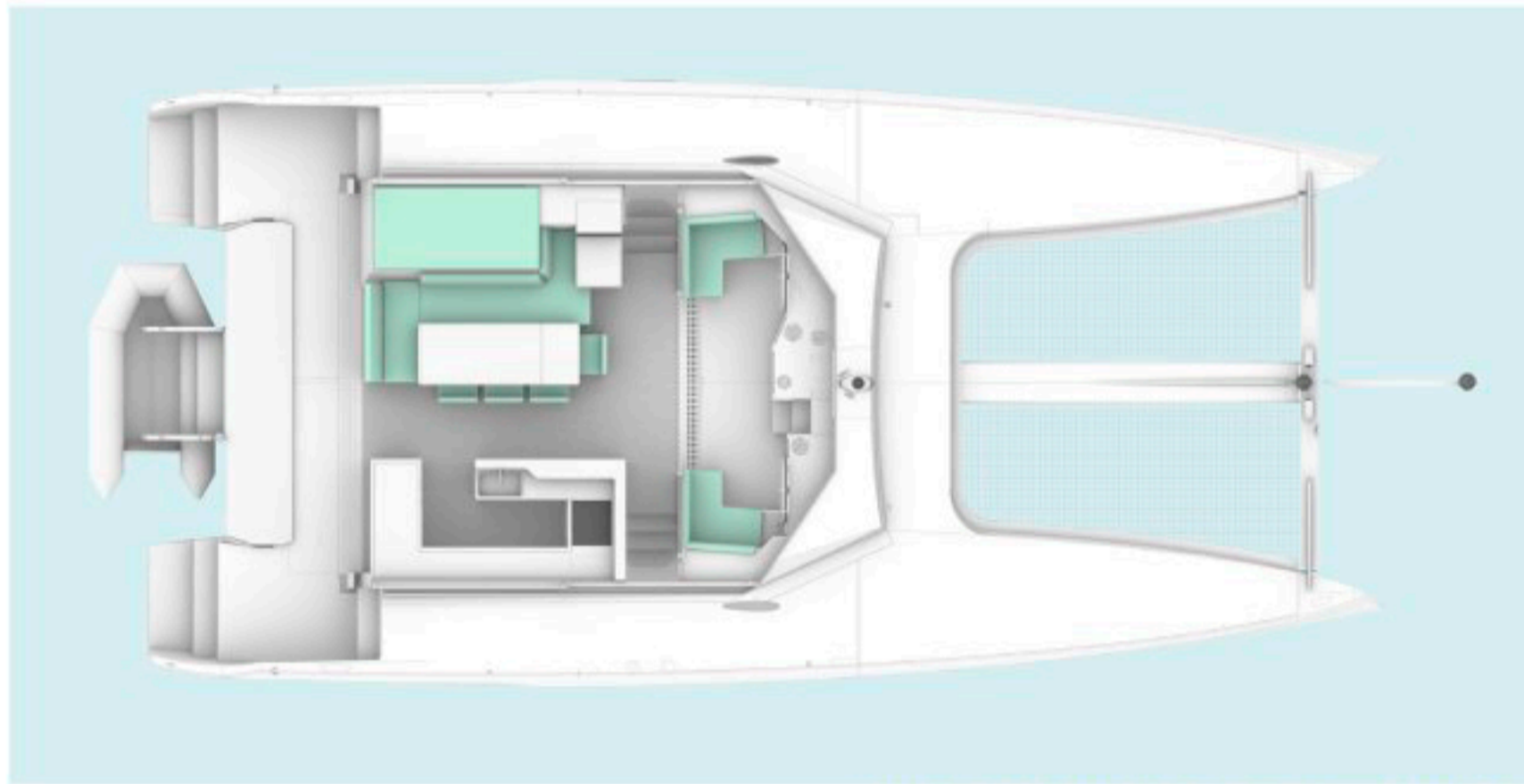

*Windelo 54 : nacelle with U-shaped galley
8 people dining table with extension, 1 pilot berth with its chart table*

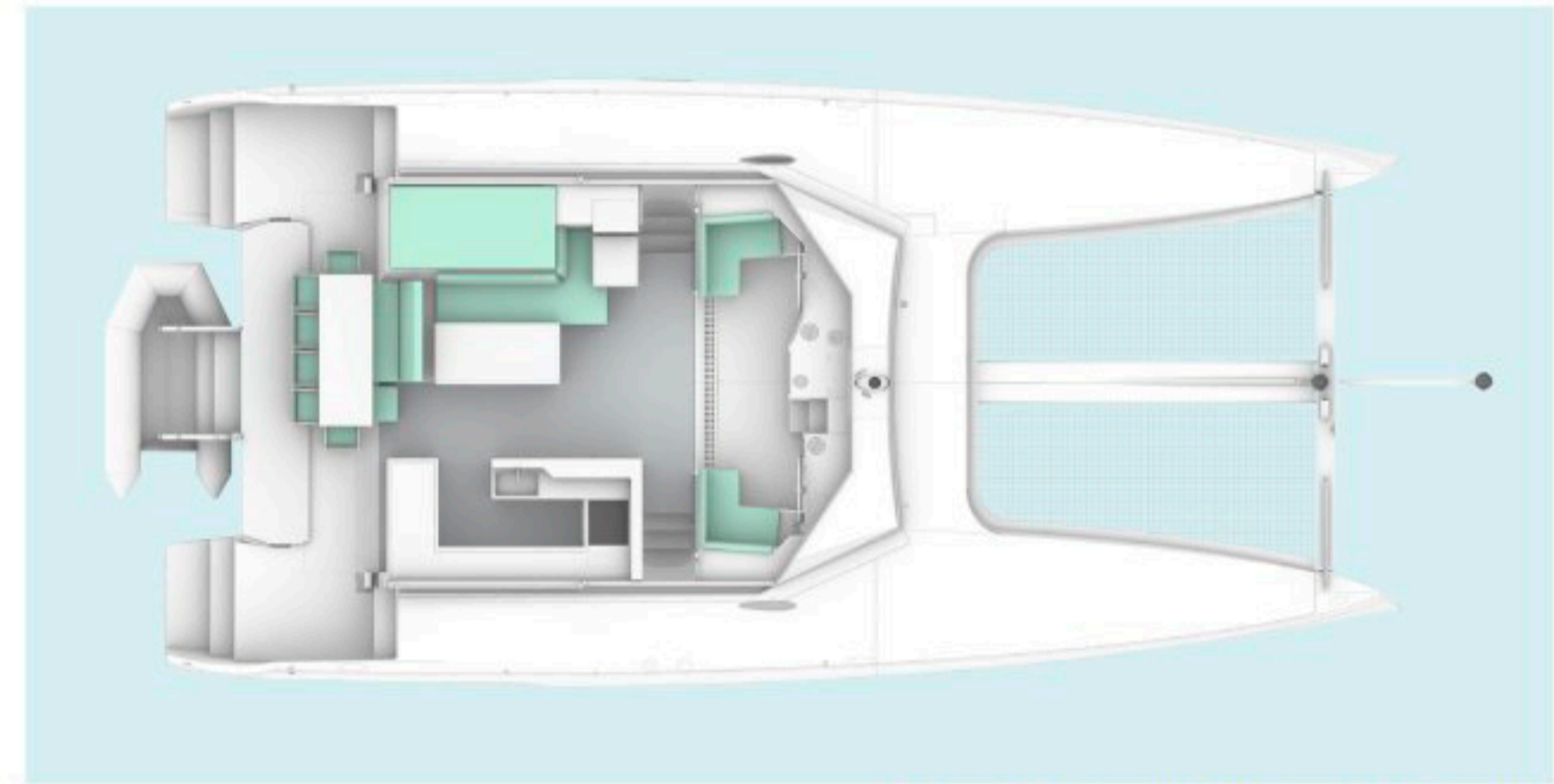

*Windelo 54 : nacelle with U-shaped galley
10 people outside dining table, 1 pilot berth with its chart table*

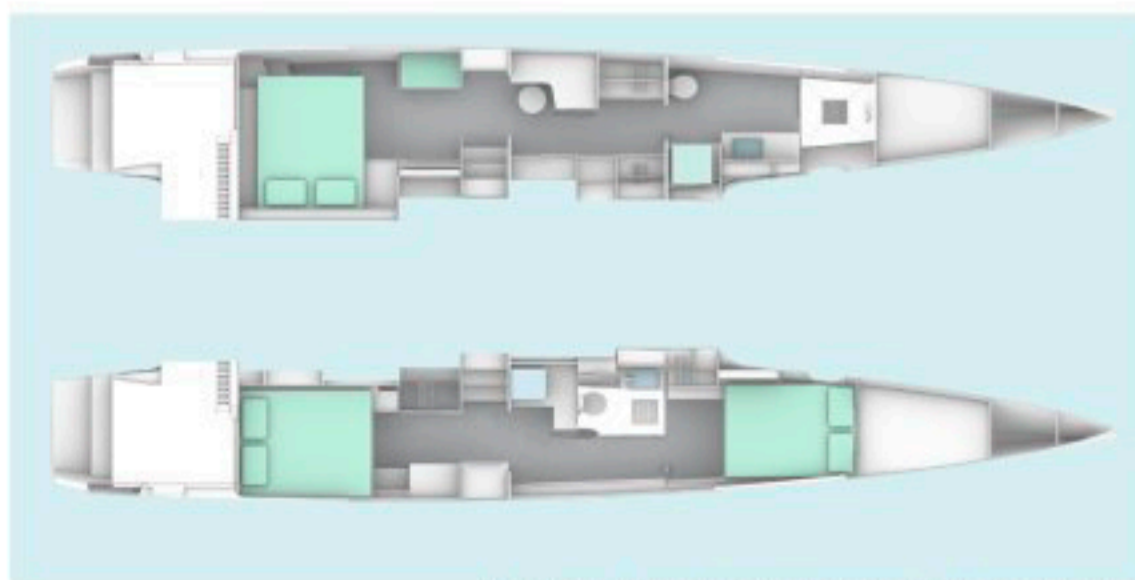

*Windelo 54 - hulls plan for nacelle with U-shaped galley
1 master cabin, 1 office and wardrobe, 1 private forward head
2 guest cabins, 1 central head, 1 central storage area*

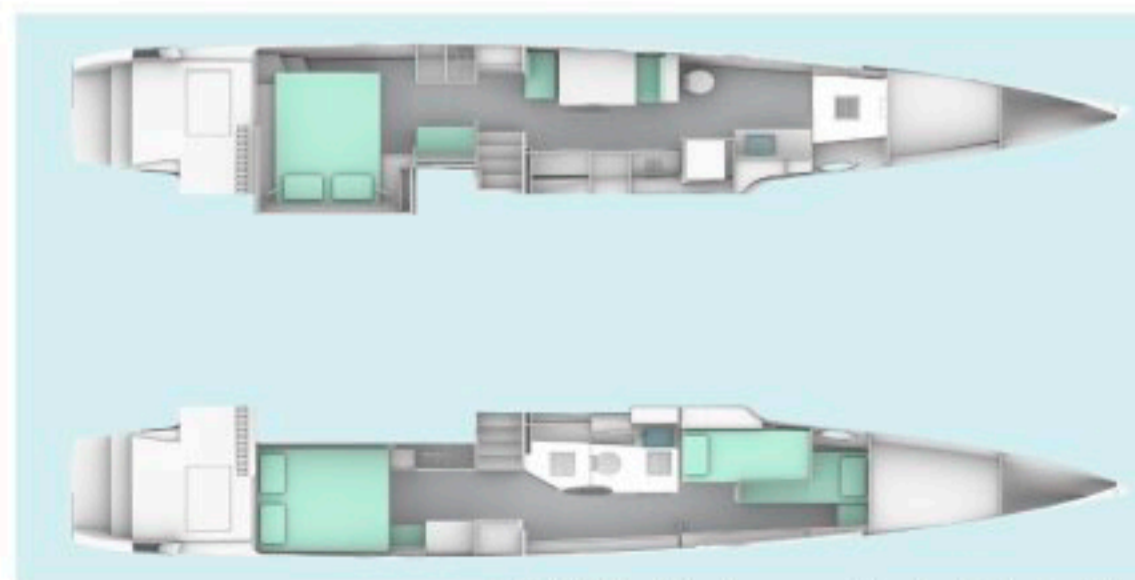

*Windelo 54 - hulls plan proposition for U-shaped galley
1 master cabin, 1 double office with its retractable berth, 1 private forward head
1 guest cabin, 1 bunk beds cabin, 2 central heads*

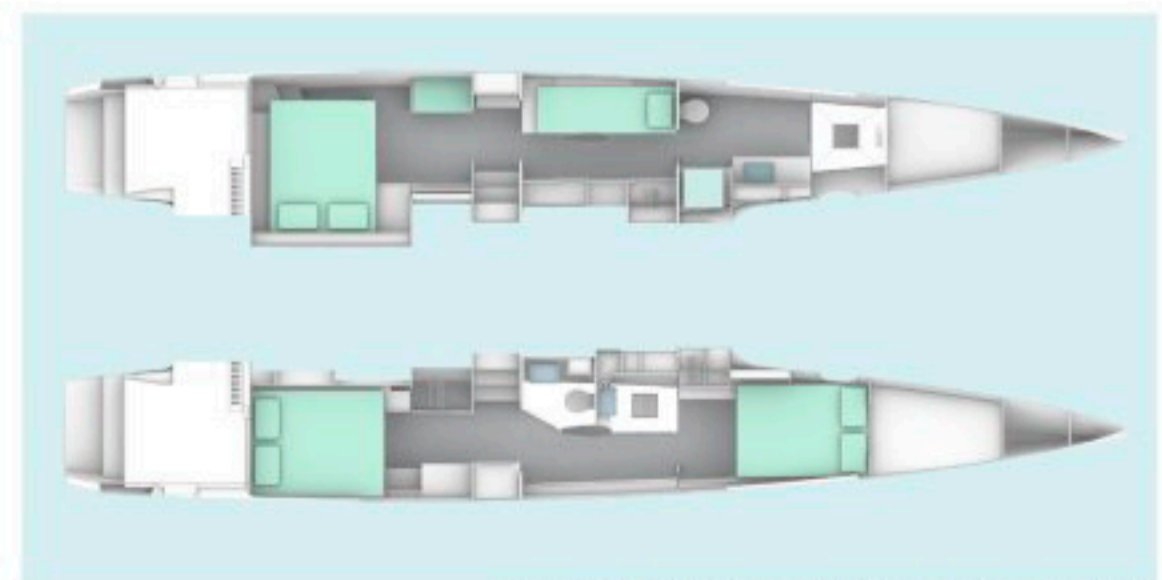

*Windelo 54 - hulls plan proposition for U-shaped galley
1 master cabin, 1 double office with its retractable berth, 1 forward head
2 guest cabins, 1 central heads, 1 separated WC*

Nacelle fitted with an L-shaped galley

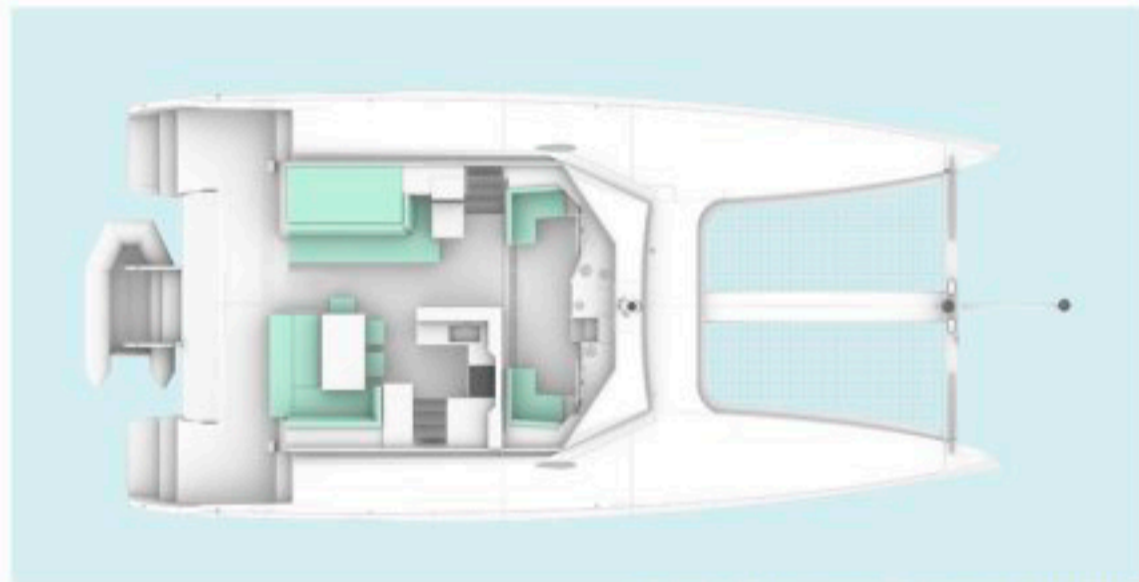

*Windelo 54 : nacelle with L-shaped galley
6 people dining table, 1 pilot berth with its chart table*

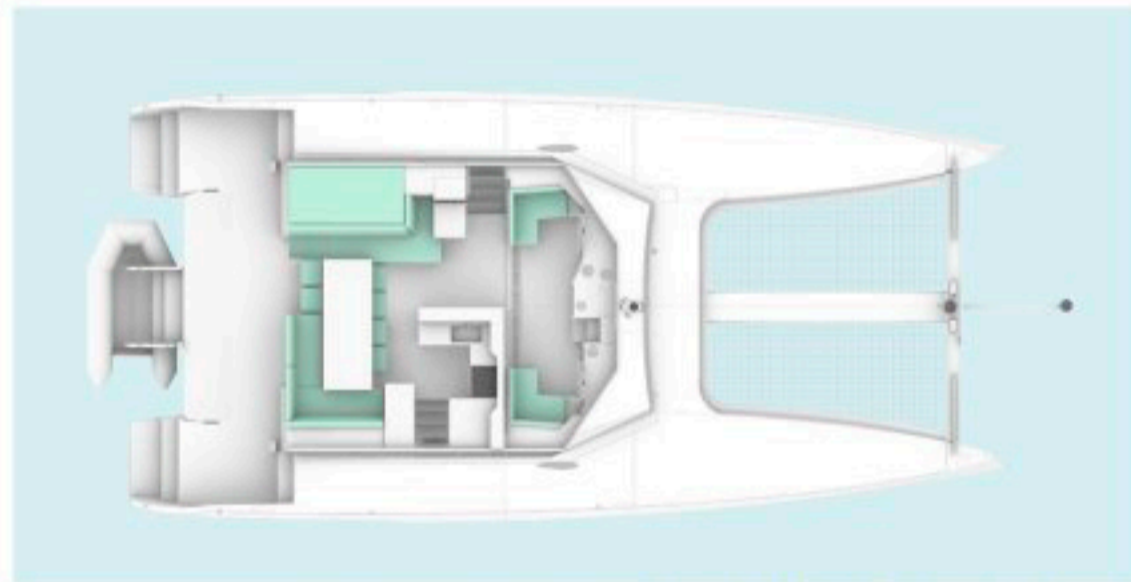

*Windelo 54 : nacelle with L-shaped galley
10 people dining table with extension, 1 pilot berth with its chart table*

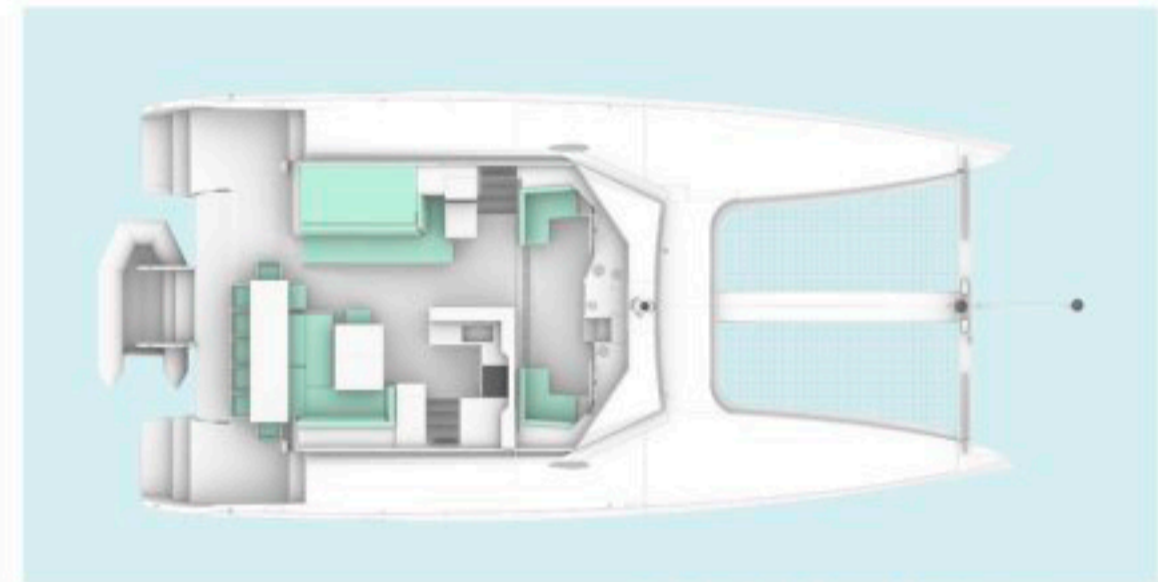

*Windelo 54 : nacelle with L-shaped galley
12 people outside dining table for anchorage, 1 pilot berth with its chart table*



*Windelo 54 - hulls plan for nacelle with L-shaped galley
1 master cabin, 1 office, 1 separated WC, 1 forward head
2 guest cabins, 1 central head, 1 central storage area*

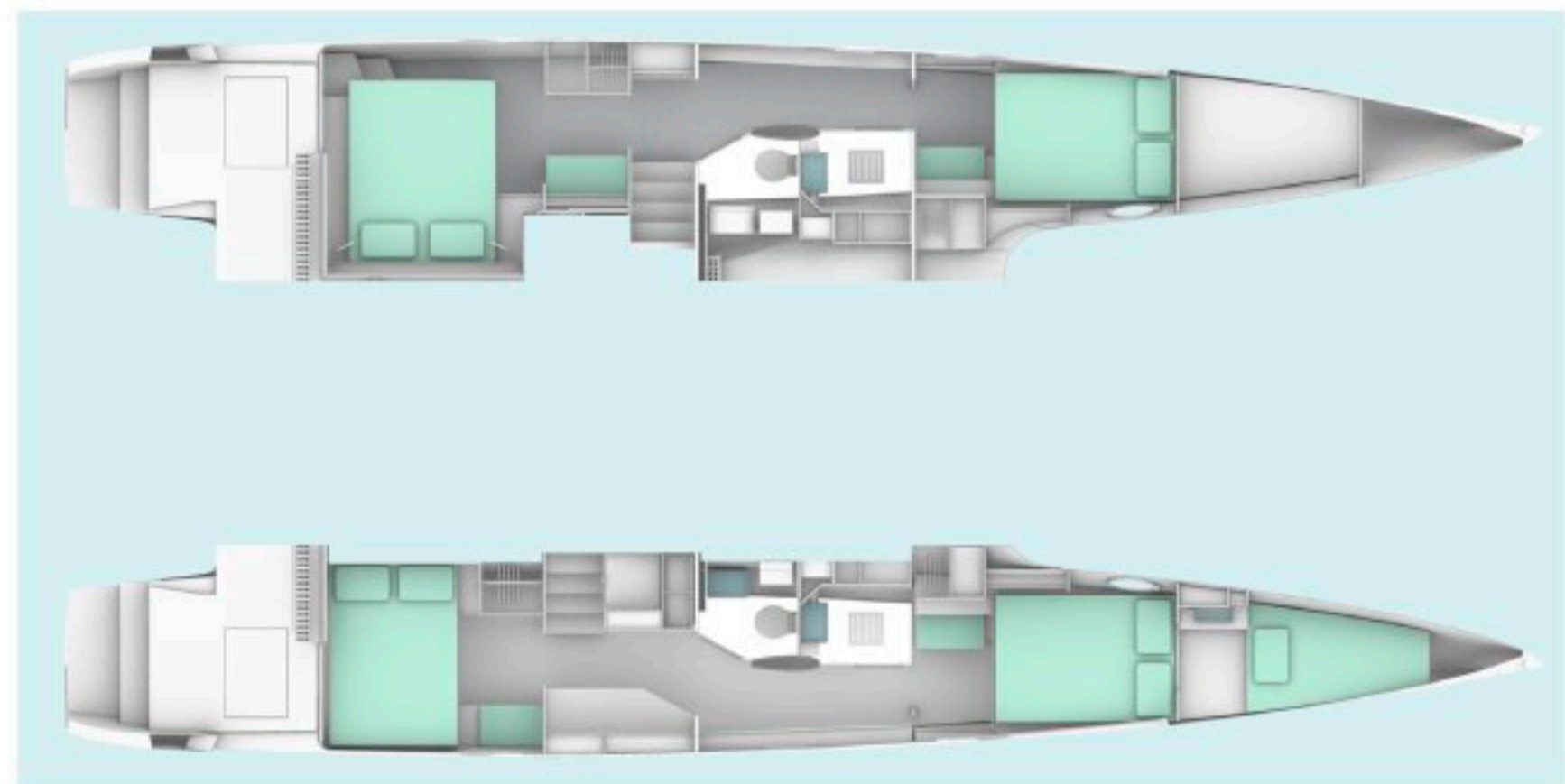

*Windelo 54 - hulls plan for nacelle with L-shaped galley
1 master cabin, 3 guest cabins, 1 skipper cabin
2 separated WC, 2 central heads*

WINDELO SPORT

Are you looking for a fast, efficient, high-performance sailboat, with comfortable living spaces? Do you love technical innovations and believe that less is more in an environmentally friendly world?

Our Sport version is a perfect fit for you. Enjoy managing resources, while achieving your full potential and feel the speed of the wind and the sea spray on your skin.



The Sport version is a high-performance boat. We have used top-quality technical materials to reduce the catamaran's weight (carbon elements, technical fabrics, etc.) The layout, equipment, and deck gear options also help to make the boat light and optimize performance under sail.

The hull structure has been strengthened, yet the boat is lighter since the composite materials and textiles have been tailored to, indoor fittings, furniture, and floors.

Specifications of the Sport version

Stylish "Performance" hull wrap

Composite longitudinal beam with no forward crossbeam to reduce forward weight

Hull structure reinforcement

White lacquered aluminum mast and boom

Textile rigging

Carbon steering wheels

Harken Performa Racing hardware

Technical materials to reduce the catamaran's weight (carbon, technical fabrics, etc.)

Hydranet square-topped battened mainsail and Hydranet self-tacking furling jib



Windelo 54 Sport



Windelo 54 Sport

MATERIALS AND TEXTURES

Standard Sport version

More choices available under options

Ceiling & linings



Silvertex aluminium

Upholstery



Sunbrella canvas pumpkin SJA



Batyline

Furniture & arrangements



Silver grey

Basalt grey

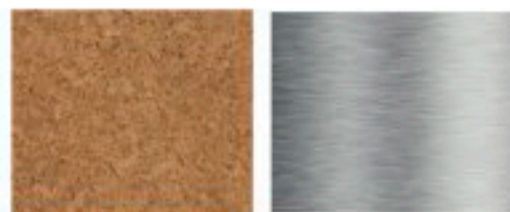

Cork

Aluminium burry

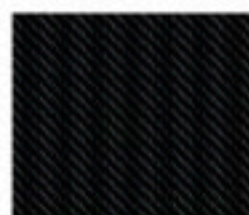

Carbone

Floors

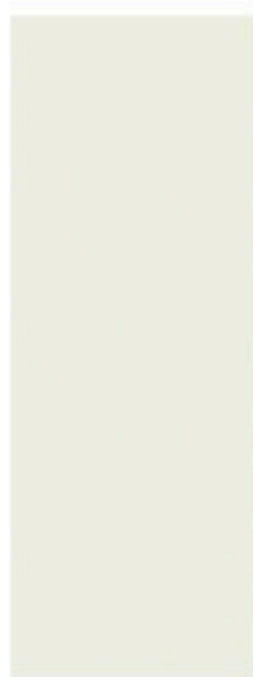

Gelcoat blanc



Windelo 54 Sport



Windelo 54 Sport



04

**Ecology, performance,
innovation & comfort**





 CLEAN FUTURE



Recycled and bio-sourced materials

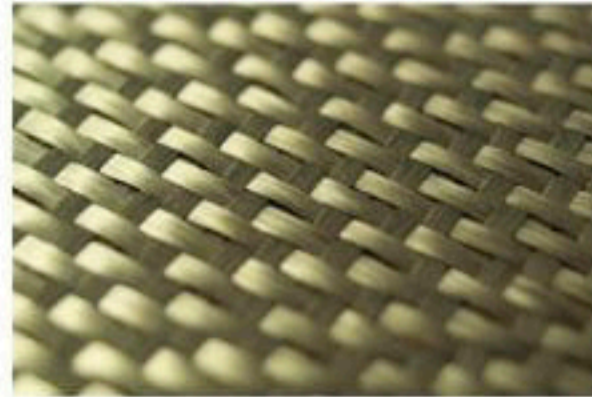
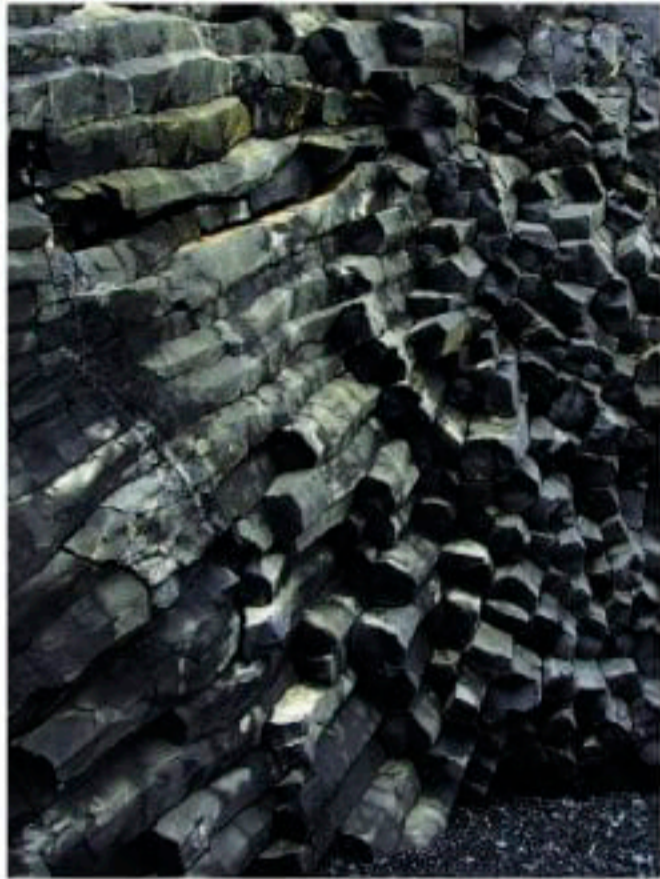

BASALT FIBERS

Basalt – yes, that’s right, the byproduct of a volcanic eruption – became the factor that solved the mystery of how to build a light, sustainable hull. Basalt fibers have been produced for many years now (in wind turbines, for instance), but Windelo is among the first to use them in yacht construction. Basalt rock is one of the main constituents of the ocean crust and is an abundant resource. No additives are needed to transform it, which reduces carbon emissions by ten.

We primarily use basalt fiber in the structure of our boats. Basalt is a natural volcanic fiber that offers vibration resistance and durability while maintaining a high strength-to-weight ratio. These basalt laminates are used to construct a stiff, light, and much more sustainable hull compared to traditional fiberglass construction. The basalt fiber presents high fire resistance, high heat resistance, and high mechanical features. The basalt fiber can be fully recycled by being redesigned in the oven and reused.



PET FOAM

Generally, yachts’ hulls are constructed using a foam core which is not very good for the environment. PET (Polyethylene Terephthalate), light and 100% recycled, gets around that issue. PET foam is a key part of the jigsaw that ensures the hull of the Windelo catamarans is far kinder to the environment than traditionally constructed ones.

PET foam is made from recycled PET, mainly from reused old drinking bottles that are crushed into very small pieces then melted again to create the PET foam. The PET core generates almost 50% less CO₂ during the fabrication process than the PVC core, a traditional material for naval constructions.

For 56% of our catamaran’s structure (hull and bulkheads), we use 80kg/m³ PET foam.

BASALT



Basalt

Basalt is the most common type of volcanic rock on earth.



Transformation into basalt fiber

Basalt fiber is a natural product made from basalt stone with no additives required.



Use and physical properties

Basalt fiber has unique fire, heat and chemical resistance, along with higher mechanical properties from 12 % to 15 % than glass fiber.

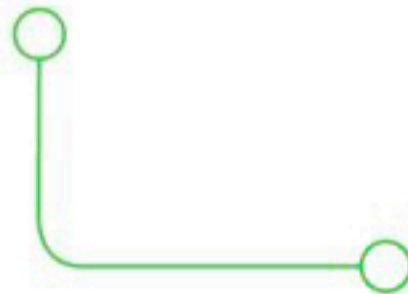

End of life and recycling

Basalt fiber is 100 % recyclable. It can be remelted in a furnace and rewoven.

SOME KEY FIGURES

- Environmental impact, energy: 91.5 kg glass = 1,000 kg basalt
- Environmental impact, carbon: 115 kg glass = 1,000 kg basalt

	BASALT	GLASS
Energy consumed over 40 years:	62.7 MJ / year	1330 MJ / year
CO ₂ consumed over 40 years:	4.25 kg / year	77.60 kg / year

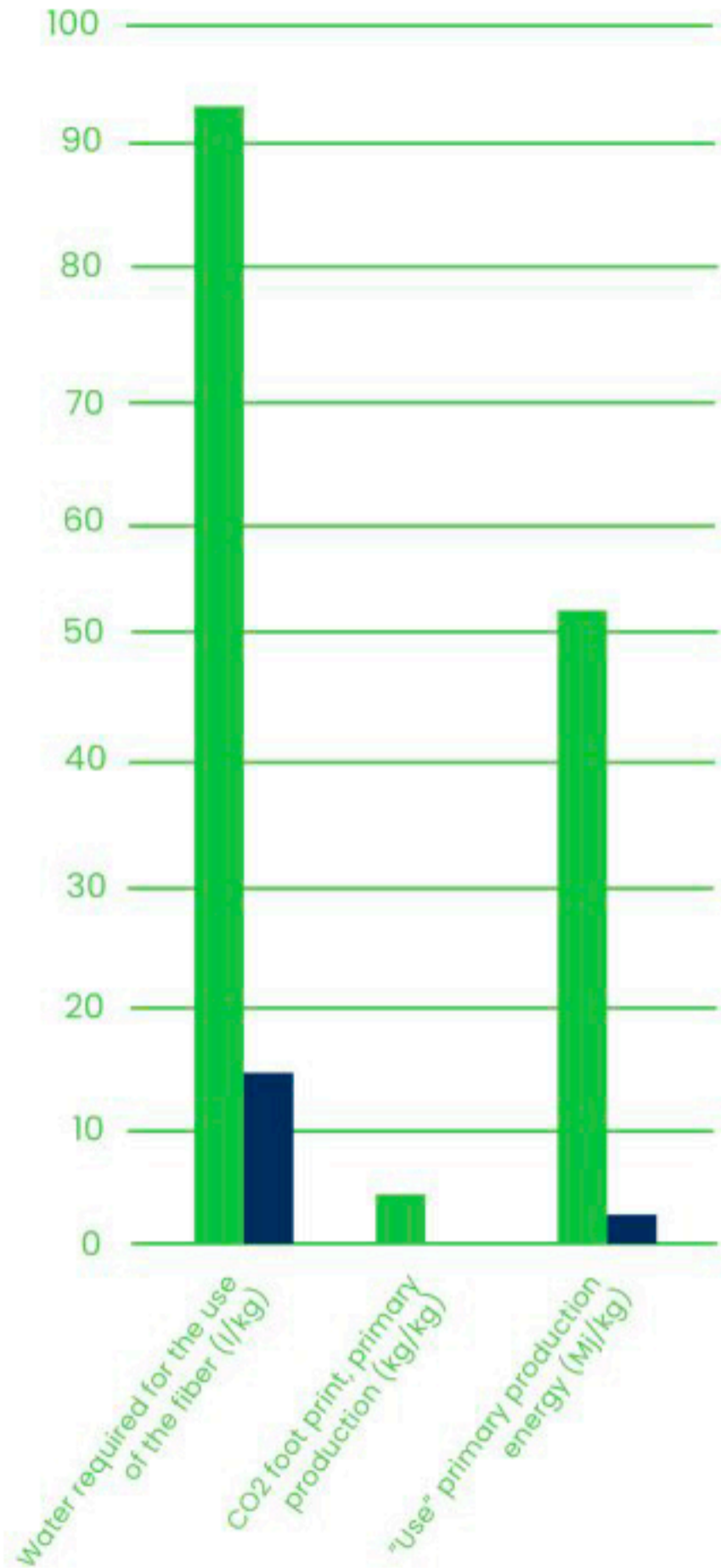

- Implementation of fiberglass
- Implementation of basalt fiber

Electric hybrid drive system & production of green energies

Building a boat that is efficient, comfortable, and in harmony with nature is the essence of the Windelo spirit. To achieve this, using an electric drive system is essential, but it is also crucial to have an extensive navigation range.

Autonomous in green energy, the Windelo is equipped with an electric hybrid drive system. This motorization consists of two 20 kW electric engines, a battery bank of 1120 Ah in 48 V as well as different charging solutions:

- Flexible or rigid solar panels from 600 to 4 500 W, for a complete charge of the batteries.
- Wind turbines of 400 W to charge the battery bank regardless of sunshine.
- A hydrogenerator that recharges the battery bank in 9 h 30 when the boat is under sails.

Windelo catamarans offer you significant autonomy if you want to sail under power only using green energies. At 6 knots, the Windelo 50 has a range of nearly 3 hours and 45 minutes, i.e. roughly 22.7 nm with an 1120 Ah battery bank.

When the energy consumed is not compensated by renewable energies, the 18 kW backup diesel generator start to supply the electric motors and recharge the batteries. When using the generators, and its 500 L diesel, the Windelo can cruise more than 1 100 miles at 6 knots under power.

Thanks to Windelo's electric hybrid drive system, you will be navigating silently even when using the engine. Enjoy the sound of the waves and undisturbed wildlife as you set sail from your dream anchorage to a new destination. No more exhaust fumes and vibrations – sailing is now a real pleasure and environmentally-friendly experience.



Windelo catamarans are equipped with a two 20 kW electric engine propulsion system, powered by a 1120 Ah 48 V battery bank

SOURCE DISTRIBUTION

TRANSFORMATION / ENERGY

DISTRIBUTION

220 V / 110 V SYSTEM



Shore supply
16 A - 32 A



Charger / Inverter
10 kVA - 15 kVA



CA 230 V / 110 V

48 V SYSTEM



Generator(s)
17.9 kW - 35.8 kW



Photovoltaic solar panels
600 W - 4500 W



Propulsion Batteries
53.8 kWh



Port Engine
20 kW



Starboard Engine
20 kW

24 V SYSTEM



Wind turbine
400 W - 800 W



Transformer
48 V / 24 V



Service Batteries
7.2 kWh - 14.4 kWh



CC 24 V

RECHARGING TIME FOR THE 53.8 kWh BATTERY BANK

Mains 220 V 16 A : **14 h 12**

Mains 220 V 32 A : **8 h 36**

1 Generator : **3 h**

2 Generators : **1 h 30**

Based on the average annual sunshine on the Mediterranean coasts in France

Flexible 600 W solar panels
4 days

Flexible 2 400 W solar panels
24 h

Flexible 4 500 W solar panels
12 h 40

Performance



All the Windelo catamarans are recognizable by their impeccable slim, well-balanced hull, designed by Christophe Barreau and Frédéric Neuman to enhance performance and seaworthiness.

Built for the pleasure of sailing and exploring, they permit a better performance than other catamarans of this size.

The well-contained proportions of the nacelle compliment the very slender floats. With a bridgedeck clearance of 90 cm, the nacelle is positioned further aft to improve the boat's passage through the sea. Good weight centering and good taut lines lessen movement when pitching – a true sign of performance and comfort.

The lengthened buoyant hull flares out above the waterline in such a way as to be sensitive to a moderate load. The peaks are slim, and the hulls narrow for greater waterline length. Volume is also provided by angling the floats 6° off the vertical axis. The load-bearing volume extends outward, thereby increasing transverse stability. Windelos are undoubtedly fast, easy to handle cruising catamarans, built for sailing seas all over the world, in safety and comfort.



Comfort & Safety



COMFORT

The team at Windelo wanted to design a yacht that becomes your comfortable home, even when you are many nautical miles from the land. It was essential to provide a feeling of both space and light in all the living areas.

The key behind creating this large open living space was to eliminate the barriers between indoor and outdoor areas. To do this, the portholes and gunwale openings have been cleverly designed to subtly blend the line between where indoor ends and outdoor begins while also letting in masses of natural light.



SAFETY

To cruise with confidence, it's vital that sailors have total faith in their boat. To this end, Windelo has ensured that our catamarans are class-leading in terms of strength. The hull features crash bulkheads, extra stringers, and hull reinforcement at key stress points.

With all the ropes and trimmings right beside the mast, the forward cockpit considerably reduces the amount of movement on the side decks and deck. Any risks for the crew are therefore limited, particularly in bad weather. Our catamarans are also carefully designed with ergonomic equipment giving the skipper a comfortable place to relax and unwind.

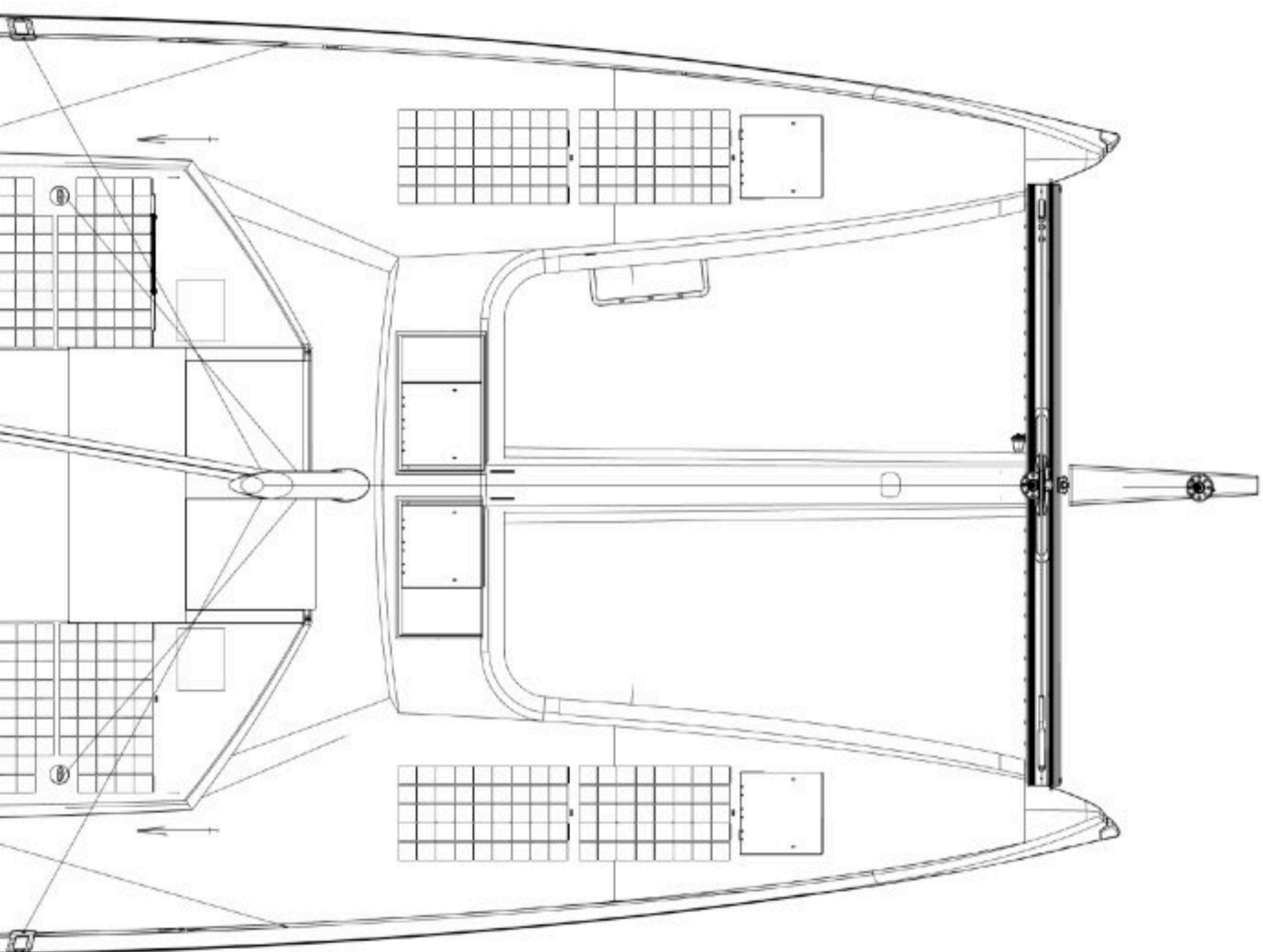



Forward Cockpit

Located just aft of the mast, the forward cockpit has a clear view of the sea and offers a wonderful helm feeling. It can be opened up when the weather conditions are beautiful; or closed off completely to protect the helmsman from the elements. The forward cockpit's fixed and sliding openings (side, ceiling, and front) offer an excellent view of the bows, sails, rigging, and the catamaran's foredeck.

By bringing all the navigation and boat controls into the cockpit, we have succeeded in modulating the space in a new way, improving the whole crew's safety and offering true pleasure at the helm.

The cockpit is modern and innovative, opening onto the saloon through completely watertight doors. The space offers unrivaled comfort and makes social interaction between the skipper and the crew a lot easier. We all agree that exploring the seas in good company is one of sailing's true pleasures.



Panoramic Views

Make the most of the sea! In keeping with Windelo's guiding philosophy, the architects Christophe Barreau and Frédéric Neuman invented a cockpit living space combined with a helm station, opening fully onto the sea. We have focused our efforts on the geometry of the material and visual limits of this space and the opening kinematics of the bays. Once opened, they "disappear" to transform the interior into an exterior.

In the rear cabins, a wide turning porthole eliminates the angle between side plating and backside. The cabin space is therefore generous despite the relative narrowness of the hulls.

The 360-degree views are achieved by a clever design that ensures the absolute maximum amount of light and a comfortable living space even if you have well-contained proportions of the nacelle and very slender floats.



Modular thinking

Instead of designing separate indoor and outdoor spaces, Windelo's solution is to offer a modular space with unmatched proportions for a catamaran of its category.

The result is a vast, single, seamless space comprising the cockpit and main galley, with a 360° view of the sea and retractable bulkheads opening it up to the fresh air.

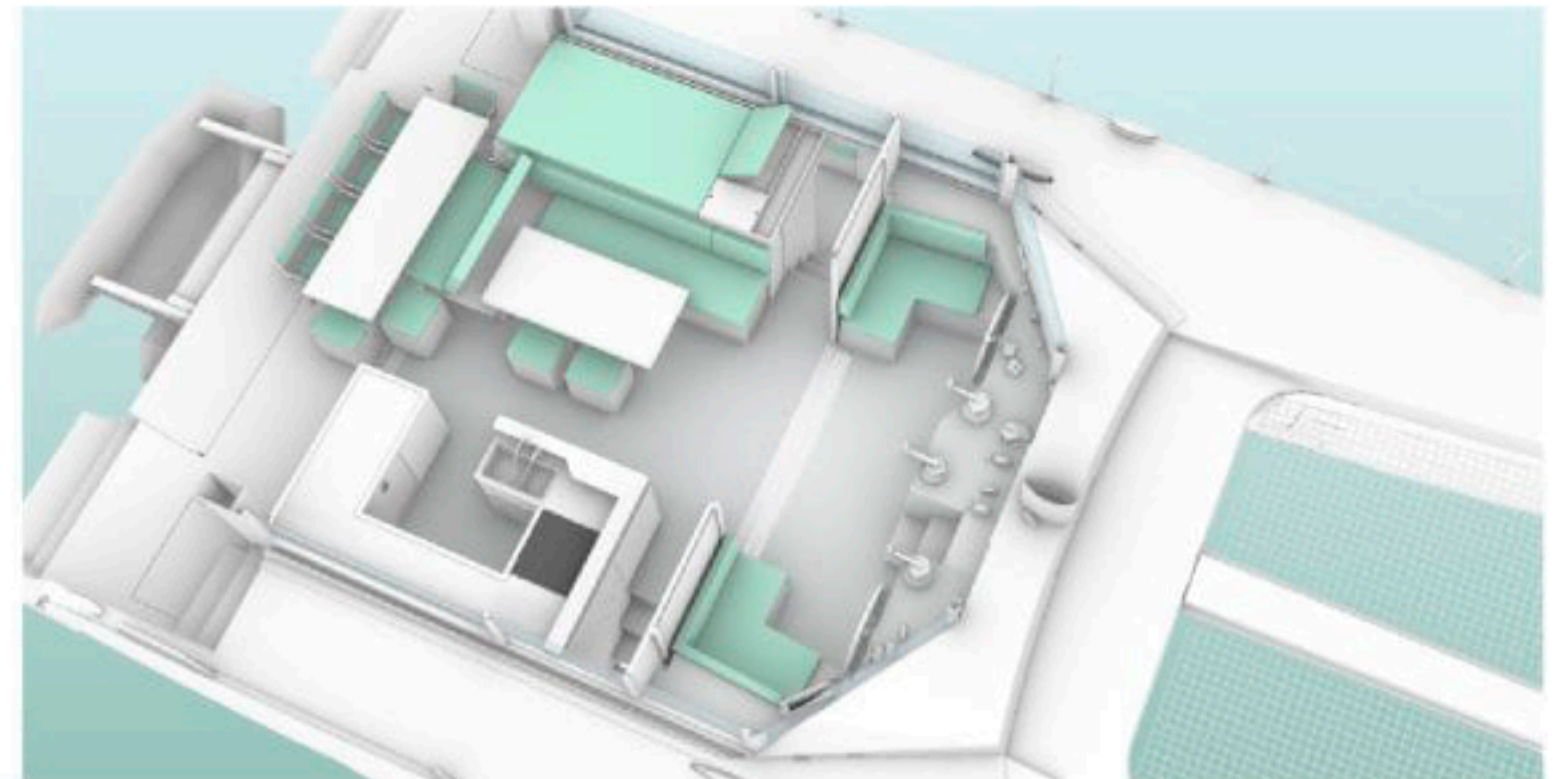
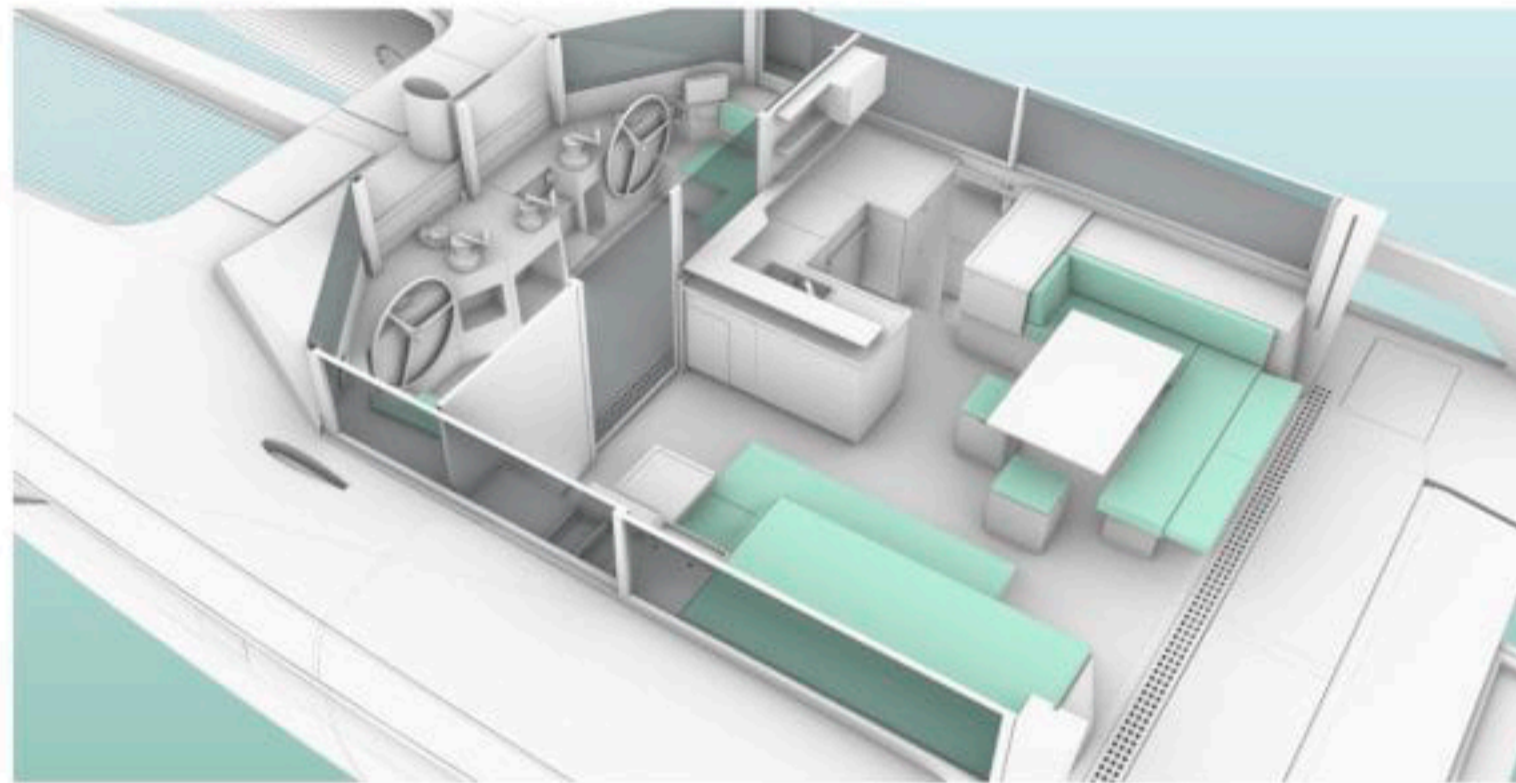

By unleashing their creativity, the architects stretched the catamaran's comfort to the limit without compromising on performance. The result is a resounding success. Christophe Barreau, who co-designed the Windelo catamaran with Frédéric Neuman, agrees: «The team welcomed new ideas regarding how space was organized. This helped us develop a very original concept that leverages all the positive features of the catamaran».

When sailing or in heavy weather, all the bulkheads can be closed to provide safety and comfort, but there

is still a panoramic view of the sea. At anchor or in light air, the openings slide away out of sight, and the indoor saloon becomes an outdoor space. This provides an unprecedented amount of comfortable space that alternates between a spacious saloon and an extensive open terrace.

This work on the modularity and the disappearance of limits is also found at the nacelle's extreme rear. When anchored, the articulated platform transforms into a floor and creates an additional space to enjoy al fresco dining.

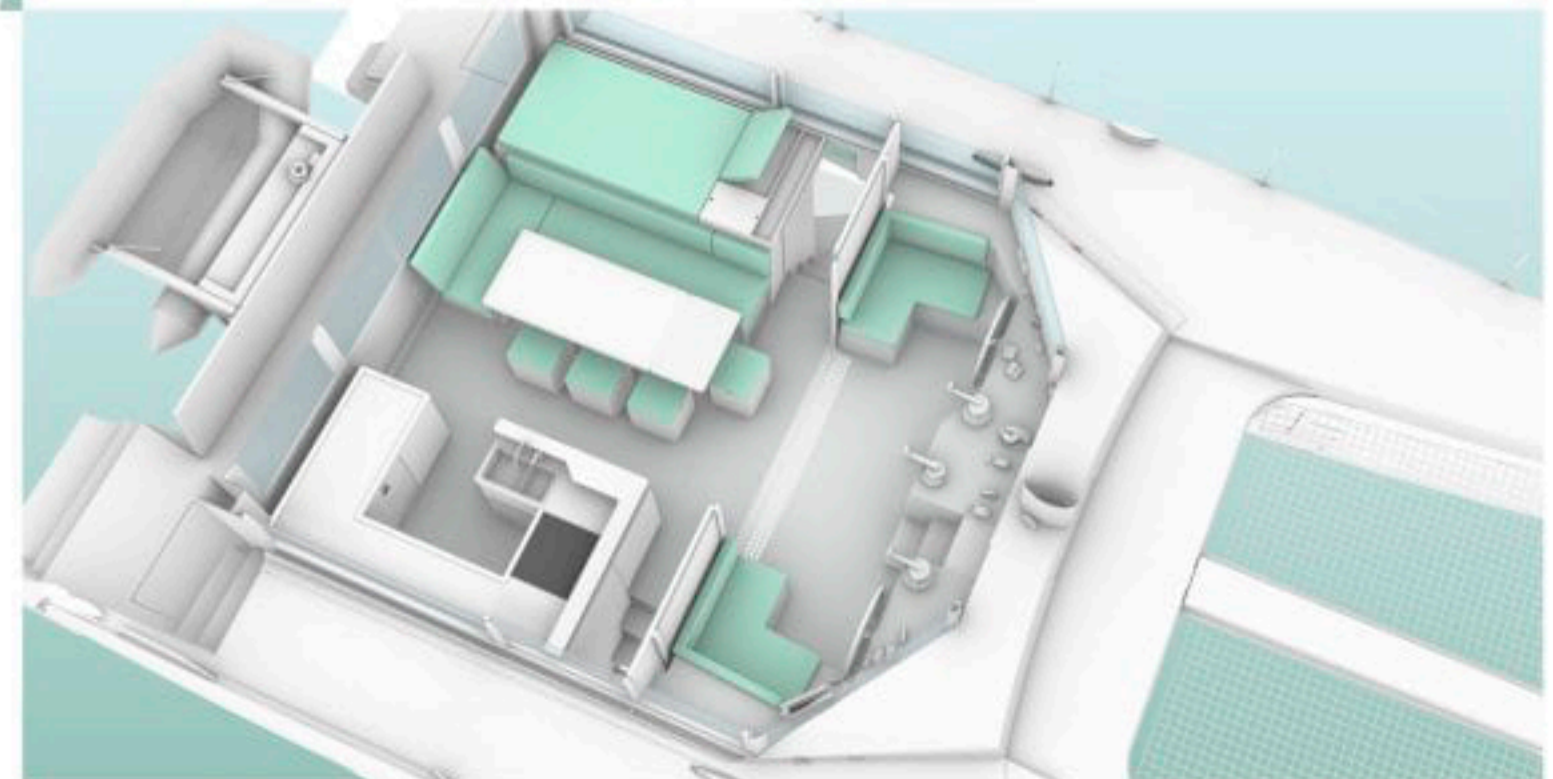

Customization



Because we are all different and none of our adventures are alike, we build unique boats for an extraordinary life experience.

All our catamarans, be it a Windelo 47, 50, 54, or 57, come in three versions: Adventure, Yachting, and Sport. Whether you are an explorer at heart, or you like to sail in high comfort, or you prefer to feel the speed of the wind, you will find a Windelo that suits you precisely!



Buying a yacht is a hugely personal thing, and we understand that each customer has their own specific set of needs. Our aim has never been to mass-produce yachts.

We will work with you to ensure that they are involved every step of the way in producing a yacht that is right for them. This means that every Windelo will be produced with the option of a high level of customization.

While the fundamental hull design will always remain the same, other aspects such as interior layout, running rigging set up even color are all open to customization.

05

Our services



As our navigations are all unique, the Windelo team offers you personalized services to accompany you in your project and during all your boat's life.



FINANCING & INSURANCE

Our privileged partners offer you adapted formulas for the financing and the insurance of your boat.



TRAINING SCHOOL

Because a boat is marine only if it is well conducted, we transmit our knowledge of navigation by offering training with the internal team or one of our partner skippers.



E-MAINTENANCE & NETWORK

An E-maintenance program to know the general condition of your boat and assist you wherever you are. We also offer a worldwide network of experts able to maintain your Windelo during your technical stopovers.



BERTH & DELIVERY

So that the berth is not a hindrance to your beautiful project, we guarantee a place for a period of 1 month on the place of construction of the boat and propose a network of worldwide partners to welcome your new Windelo.



RENTAL

We offer a worldwide network of rental companies offering rental management and associated services (maintenance, berth, concierge etc ...).



REFIT & RESALE

We accompany you for the refit and the resale of your catamaran.

06
Meet us

Windelo
CLEAN FUTURE



WINDELO, a «Made In France» shipyard in Occitania region

Our shipyard is located in the port of Canet-en-Roussillon and was inaugurated in March 2021. Our production facility is tailored to our industrial process. It was designed to accommodate new developments in our boat range and satisfy increases in demand.

Setting up the facility in the Occitania region was a strategic choice. It enables Windelo to benefit from all the expertise and infrastructures on offer at the port of Canet-en-Roussillon. The 4000 sq. m quayside plot is the first development phase for the boatyard. The diversity of professionals and facilities in the area make it a hub of excellence for every aspect of the catamaran business. Following the evolution of the project, we could gradually expand our facilities to 10,800 sq. m.

It houses all the services needed to build and market our boats, including a design office, marketing, sales and administrative departments, and component manufacturing, assembly and fitting workshops.



Contact us and meet us

A project? Meet our team on-site or in virtual!

Do you have a catamaran purchase project or would you like to learn more about our brand and our catamarans? Want to clarify some specific point?

Our Friday open days are for you! You can make an individual appointment with our team on-site or in virtual (video conference or telephone).



+33 4 11 30 01 43



contact@windelo-catamaran.com



For more information,
please contact our sales team



+33 4 11 30 01 43



contact@windelo-catamaran.com